



PERFORMANCE SPECIFICATIONS

Brightness ($\pm 10\%$)

HIGHlite 330-3D-HC: 3000 Lumens
HIGHlite 330-3D-HB: 5500 Lumens

Contrast:

HIGHlite 330-3D-HC: 20,000:1
HIGHlite 330-3D-HB: 2,000:1

Display Type

Texas Instrument DMD 0.65" x 3,
DDR DLP Darkchip

Native White

D65

Native Resolution

1920 x 1080 pixels

Computer Compatibility

Up to 1920 x 1200

Video Compatibility

NTSC, SECAM, PAL, HDTV, HDCP
on HDMI 1.4,

Bandwidth (up to)

200 mHz on analog RGB
165 mHz on HDMI

Throw Ratio

.77:1 fixed
1.16:1 fixed
1.45 - 1.74:1 zoom
1.80 - 2.17:1 zoom
2.17 - 2.90:1 zoom
2.90 - 4.34:1 zoom
4.34 - 6.76:1 zoom

* HL Cine 330 HC requires High Contrast lenses
* HL Cine 330 HB require High Brightness lenses

Image Size

40" - 224"

Image Offset

60% vertical, 15% horizontal

Lamp Life (Typical)¹

2,000 hours

Mechanical Mounting

Front/rear table
Front/rear ceiling
Adjustable front/rear feet

Operating Noise Level

<36dB

Dimensions (chassis and feet only)

H: 8.6 inches 218.6 mm
W: 19.7 inches 499.2 mm
L: 19.7 inches 500.6 mm

Weight (chassis only)

47 lbs.

Cabinet Color

Graphite with carbon fiber finish top

Overview

Digital Projection International (DPI), Texas Instruments' first DLP™ partner and the original innovator of the 3-chip DLP™ projector, announces a bold 3D addition to their powerful but value-driven HIGHlite Cine 3-chip DLP series. Delivering up to 5500 lumens of brilliant imagery, the new HIGHlite 330-3D displays include two versions: a 20,000:1 high contrast version, and a 5,500 lumen high brightness version. Particularly noteworthy is the HIGHlite 3D's conservative price points for such advanced displays.

Brightness is an essential characteristic when selecting a 3D projector for any venue. Of paramount importance in any projector, however, is the overall image quality in both 2D and 3D modes. With up to 4500 lumens on tap, the new HIGHlite 330-3D models provide more than enough brightness to thrive in dedicated theaters and venues with controlled light, as well as in venues with some ambient light such as media rooms and education facilities. The compact and quiet chassis, 1080p resolution, broad source connectivity and straightforward user interface make the HIGHlite 330-3D ideal projector solutions for installations needing exceptional 2D and 3D imagery with stellar 3-chip imaging, contrast and color performance. Augmenting these benefits are the overall efficiency and long-life of the lamp system, enabling this new platform to produce beautiful 2D and 3D imagery while consuming very low power and producing very little noise and heat.

Providing a bright, saturated image from a small-form 3-chip display, the HIGHlite 330-3D displays present powerful yet remarkably affordable solutions for a variety of home entertainment applications, including:

- Home theaters and media rooms
- Training and education
- Boardrooms and conference centers
- Process control and command & control
- Visualization/simulation environments
- Retail and entertainment
- Digital media/advertising and hospitality

Installation is flexible due to the HIGHlite 330-3D's compact chassis design and extraordinary lens shift range of 120% vertical and 30% horizontal. Multiple lens options provide further flexibility, with .77 and 1.16:1 fixed lenses plus zoom lenses with throw ratios ranging from 1.45 – 6.76:1. HIGHlite 330-3D connectivity includes two HDMI inputs, as well as RGB via D-15, component, composite and S-Video inputs.

As is the case with all Digital Projection displays, our careful engineering assures the HIGHlite Cine series provides reliable, best-in-class performance for years to come. Equally important, our legacy in superior customer and technical services guarantees our experienced support staff is always available to address your needs.

INPUT / OUTPUT CAPABILITIES

Input*	Connector	Quantity
VGA	D Sub (15-pin)	1
HDMI	HDMI 1.4	2
Component Video	RCAX3	1
(SDTV/HDTV)	BNC x 5	1
S-Video	4-pin mini DIN	1
Composite Video	RCA	1
Remote Control	3.5mm stereo jack- female	1
Screen/Aspect trigger	3.5mm mini-sub	2
RS232	9 pin DSUB	1
LAN	RJ45	1

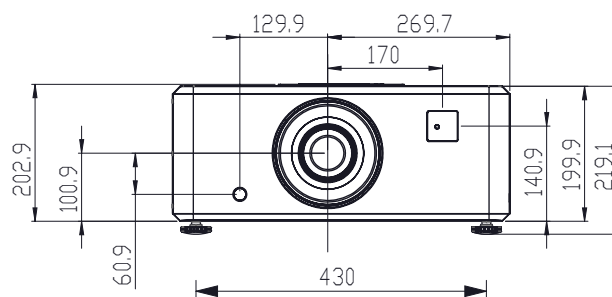
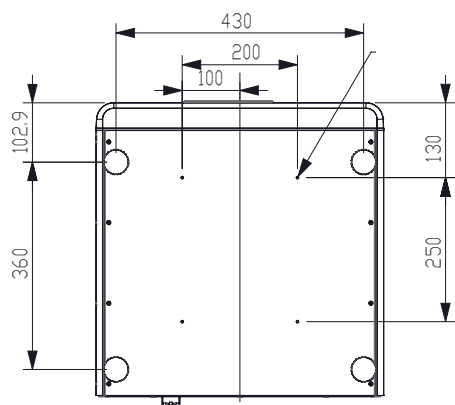

Projector Dimensions

Projector dimensions (in)
L1 20.2 W1 15.2 H1 8.2

Projector dimensions (mm)
L1512 W1 499 H1 219

HIGHlite 330 Input Panel

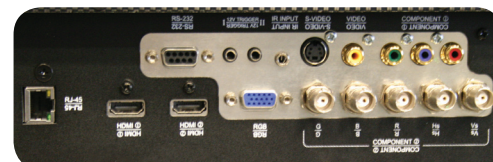

ADVANCED TECHNICAL SPECIFICATIONS

PARAMETERS

HDTV Formats Supported	1080p, 1080i, 720p, 576i/p, 480i, 480p
Scan Rates Supported	Vertical 43-85 HZ; Horizontal TBA
Remote Control	Remote wireless IR
Automation Control	LAN connection via RJ45 / RS232 9-pin D sub
Operating/Storage Temperature	Operating: 0 to 40°C at 0-7500' / Storage: -20°C to 60°C
Operating Humidity	20% to 85% non-condensing
Thermal Dissipation	1706 BTU/hour
Fan Noise	<36dB
Power Requirements	110-120/200-240 VAC, 47-63 Hz (Auto-Ranging)
Power Consumption	530W
Safety and EMC Regulations	FCC-A, UL, C-UL, CE

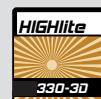

Projector

HIGHlite 330-3D-HC
HIGHlite 330-3D-HB

Part

113-123
113-411

HIGHlite Cine Lenses HB

.77:1 fixed lens
1.16:1 fixed lens
1.45 - 1.74:1
1.74 - 2.17:1
2.17 - 2.90:1
2.90 - 4.34:1
4.34 - 6.76:1

Part

110-808
110-809
110-803
110-804
110-805
110-806
110-807

HIGHlite Cine Lenses HB

.77:1 fixed lens
1.16:1 fixed lens
1.45 - 1.74:1
1.74 - 2.17:1
2.17 - 2.90:1
2.90 - 4.34:1
4.34 - 6.76:1

Part

110-022
110-023
110-017
110-018
110-019
110-020
110-021

Accessories

330 Watt Lamp and Housing
HIGHlite Cine Adjustable Ceiling Mount
Infrared Remote for HIGHlite Cine Models
Adapter Plate for TheaterScope Swing System

Part

111-100
111-182
110-024
111-183



¹ Based on 4-6 hour/day operational profile. Venue and application conditions may impact actual lamp life.

See Digital Projection's Product Warranty Statement for details on lamp warranty.